

GRID MEMBER LEGEND	
	1 1/2" SCH. 40 PIPE
	12" BOX TRUSS

GRID LOAD TABLE

ENTIRE GRID	
1) UNIFORMLY DISTRIBUTED LOAD	11 PSF
2) PT LOADS @ 5'-0" O.C.	275 LBS

TRUSS LOAD TABLE

12" BOX TRUSS	60 PLF	600 LBS	2 @ 500 LBS

NOTE: FULLY LOADING MULTIPLE GRID MEMBERS IN A LOCALIZED AREA MAY OVERSTRESS THE ROOF STRUCTURE. THE LOAD RATINGS SHOWN ABOVE ARE INDEPENDENT OF ONE ANOTHER.

STAGE 10 ROOF & GRID VIEW
SCALE: 1/16" = 1'-0"

DATE	REV	ISSUED FOR USE	DESCRIPTION	BY	CHK'D	APP'V
2/1/2021	0	ISSUED FOR USE	DESCRIPTION	EIP	JN	JN
			REVISIONS			



DRAWN BY: EIP	CHK'D BY: JN
DESIGNED BY: EIP	APP'V'D BY: JN
JOB NO. QUI-004	SCALE: AS NOTED
CAD FILE: QUI-004-D-4-0	DATE: 2/1/2021

ENGINEER: HOPPER ENGINEERING ASSOCIATES
300 VISTA DEL MAR
REDONDO BEACH, CALIFORNIA 90277
(310) 373-5573
<http://www.hopperengineering.com/>

SHEET TITLE: PLAN VIEW AND LOAD RATINGS		
PROJECT/OWNER: QUIXOTE GRIFFITH PARK - STAGE 10		
4585 ELECTRONICS PLACE LOS ANGELES, CA 90039		
HEA DRWG NO. QUI-004-D-4-0	DRWG NO.	SHT NO. 2 / 2
		REV. 0

Quixote Griffith Park Grid Layout Stage 10

4585 Electronics Pl.
Los Angeles, CA 90039
323 851 5030
Bookings@Quixote.com
Quixote.com



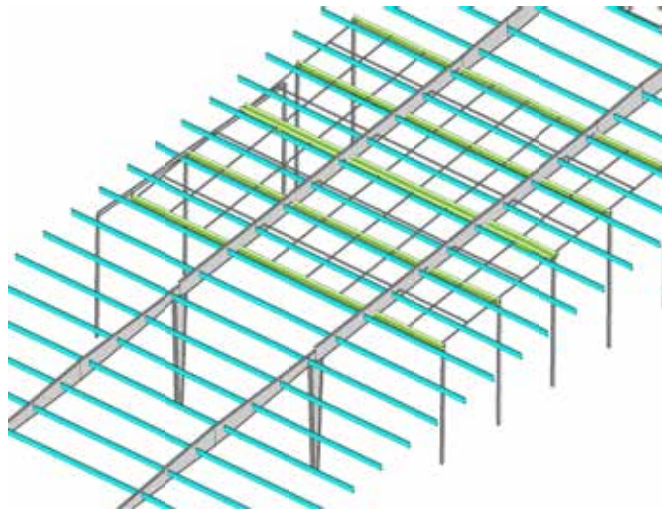

ISO VIEW
N.T.S.

Length - 98'
Width - 58'
Grid Height - 16' to 18'

GENERAL NOTES:

- LOADING SCENARIOS OTHER THAN THOSE SHOWN ON SHEET 2 MUST BE VERIFIED BY A CA LICENSED ENGINEER.
- RIGGING COMPONENTS AND CONFIGURATIONS WITH A TOTAL ROOF LIVE LOAD EXCEEDING 12,000 LBS MUST BE VERIFIED BY A CA LICENSED ENGINEER.
- ALL RIGGING LOADS ARE CONSIDERED TO BE DEAD HUNG. PLEASE CONSULT A CA LICENSED ENGINEER IF BRIDLING IS REQUIRED.
- LOADS SHOWN ARE STATIC LOADS. IF DYNAMIC LOADS ARE ANTICIPATED, THE LOADING MUST BE REVIEWED BY A CA LICENSED ENGINEER AND STUDIO OPERATIONS.
- ADDITIONAL ROOF LIVE LOADS SUCH AS LARGE NUMBER OF PEOPLE AND/OR MISCELLANEOUS EQUIPMENT IS NOT ALLOWED SIMULTANEOUSLY WITH THE RIGGING LOADS PROVIDED. IF ADDITIONAL ROOF LIVE LOADS ARE ANTICIPATED, THE LOADING MUST BE VERIFIED BY A CA LICENSED ENGINEER.
- MODIFICATIONS TO THE STAGE MADE AFTER DECEMBER 2020 MAY AFFECT THE LOAD CAPACITIES.
- A ROOF LIVE LOAD OF 4 PSF WAS USED IN THE ASCE 7-16 LOAD COMBINATIONS FOR THIS ANALYSIS. THIS IS NOT CONSISTENT WITH THE CODE REQUIRED ROOF LIVE LOAD OF 12 PSF. IF EITHER LOADS IN EXCESS OF 4 PSF OR TOTAL LOADS EXCEEDING 1,400 LBS ARE ANTICIPATED ON THE ROOF WHILE RIGGING IS INSTALLED, PLEASE CONSULT A CA LICENSED ENGINEER.



OVERALL GRID VIEW



GRID END ATTACHMENT



GRID ROOF ATTACHMENT

DRAWN BY: EJP		CHK'D BY: JN		SHEET TITLE: ISO VIEW AND STAGE INFO				
DESIGNED BY:		APP'D BY: JN		PROJECT/OWNER: QUIXOTE GRIFFITH PARK - STAGE 10				
JOB NO: QUI-004		SCALE: AS NOTED		4585 ELECTRONICS PLACE				
CAD FILE: QUI-004-D-4-0		DATE: 2/1/2021		LOS ANGELES, CA 90039				
ENGINEER: HOPPER ENGINEERING ASSOCIATES				HEA DRWG NO. QUI-004-D-4-0				
300 VISTA DEL MAR				DRWG NO.				
REDONDO BEACH, CALIFORNIA 90277				SHT NO. 1				
(310) 373-5573				REV. 2				
http://www.hopperengineering.com/				0				
DWG NUMBER	TITLE	DATE	REV	ISSUED FOR USE	DESCRIPTION	BY	CHK'D	APPR'V
	REFERENCE DRAWINGS	2/1/2021	0			EJP	JN	JN
					REVISIONS			

